



Bridgewater

Estates & Lettings



10 The Chestnuts Higher Lane, Lymm, WA13 0BG

This well presented 1st floor studio apartment is offered to let on an unfurnished basis. The property briefly comprises of entrance hall, a combined lounge, bedroom and kitchen and a separate bathroom.

There is ample parking within the grounds.

A new boiler has recently been installed in the property.

Lymm village is only a short walk away and has a good selection of bars, restaurants and shops

- Studio apartment
- 1st floor
- Parking
- Unfurnished
- EPC level C

£575 PCM

10 The Chestnuts Higher Lane, Lymm, WA13 0BG





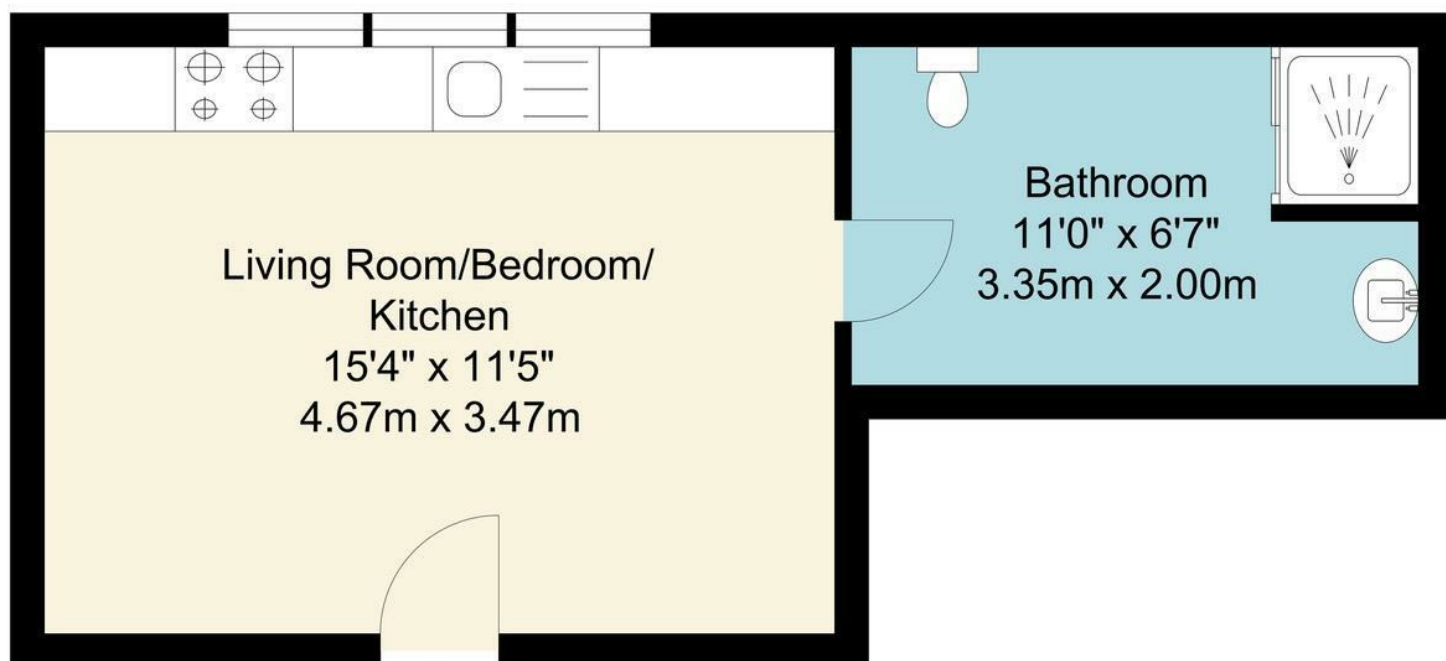

TOTAL APPROX FLOOR AREA 248.64 SQ.FT. (23.10 SQ. M.)

Whilst every attempt has been made to ensure the accuracy of the floor plan contained here, measurements of doors, windows, rooms and any other items are approximate and no responsibility is taken for any error, omission or misstatement. This plan is for illustrative purposes only and should be used as such by any prospective purchaser.

Energy Efficiency Rating		
	Current	Potential
Very energy efficient - lower running costs		
(92 plus) A		
(81-91) B		
(69-80) C		
(55-68) D		
(39-54) E		
(21-38) F		
(1-20) G		
Not energy efficient - higher running costs		
England & Wales	EU Directive 2002/91/EC	

Environmental Impact (CO ₂) Rating		
	Current	Potential
Very environmentally friendly - lower CO ₂ emissions		
(92 plus) A		
(81-91) B		
(69-80) C		
(55-68) D		
(39-54) E		
(21-38) F		
(1-20) G		
Not environmentally friendly - higher CO ₂ emissions		
England & Wales	EU Directive 2002/91/EC	

